

# WOLTERS ENGINEERING

ENGINEERING, DRAFTING, CONSULTING

15211 97<sup>th</sup> Road N  
West Palm Beach, FL 33412  
Ph/Fx: (561) 225-1982

## PRODUCT EVALUATION

PRODUCT: ABRAMS AAP-700 (MALE/FEMALE) WALL CLADDING SYSTEM

MANUFACTURER: ABRAMS ARCHITECTURAL PRODUCTS  
7260 DELTA CIRCLE  
AUSTELL, GA 30166

To all concerned,

The AAP-700 (Male/Female) Wall Cladding System, manufactured by Abrams Architectural Products, is a Composite Metal Panel System consisting of 4mm Alucobond panels with extruded aluminum framing, fastened to 5/8" CDX plywood over 16 Ga. metal stud framing (min). The system has been tested per TAS 201, 202, and 203 by Intertek B&C, with results shown in test report K3255.03-550-18.

### Technical Documentation:

1. Drawing "AAP-700" dated 6/4/20, signed and sealed by Scott Wolters, PE.
2. Test Report listed above by Architectural Testing, Inc. signed and sealed by Vinu Abraham, PE.
3. Supplemental Calculations to support "AAP-700" drawing, signed and sealed by Scott Wolters, PE.

I have reviewed this submittal per the requirements of FAC Product Approval Rule Chapter 61G20-3.005 (4). Based on the limitations listed below and those provided in the documents above, this product meets all the requirements of the 6<sup>th</sup> Edition (2017) Florida Building Code generally, and chapters 14, 16, and 20 specifically, including the HVHZ provisions.

Limitations: This MCM Panel System is small missile impact resistant and approved for use inside and outside of the HVHZ. Elevations in windborne debris regions below 30 ft may only be installed over wall types listed in FBC Section 1626.4.

<u>Overall Dimensions:</u>	Maximum Panel Width:	82 3/4"
	Maximum Panel Height:	60"
	Maximum Stiffener Spacing:	20"
	Maximum Design Pressure:	+/- 130 psf

This system is further limited as noted in installation drawing "AAP-700"

If you have any questions or need more information concerning this approval please contact me.

Thank you,

  
Scott Wolters  
FL PE# 62354

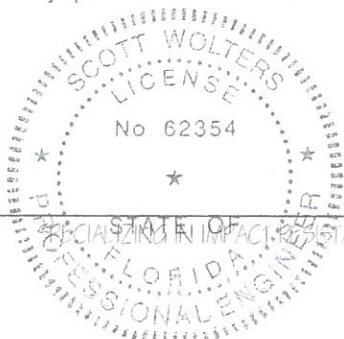

JUN 05 2020

# ABRAMS AAP-700 (MALE/FEMALE) WALL CLADDING SYSTEM:

## GENERAL NOTES:

1. THIS SYSTEM HAS BEEN DESIGNED TO MEET ALL OF THE REQUIREMENTS OF THE 2017 FLORIDA BUILDING, INCLUDING THE HVHZ PROVISIONS.
2. THIS SYSTEM HAS BEEN TESTED PER TAS 201, 202, AND 203 FOR SMALL MISSILE IMPACT RESISTANCE. IN WINDBORNE DEBRIS REGIONS, ELEVATIONS BELOW 30 FT. MAY ONLY BE INSTALLED OVER WALL TYPES LISTED IN FBC SECTION 1626.4
3. THE METAL STUD WALL IS NOT A PART OF THIS SYSTEM. THE METAL STUD SYSTEM MUST ADEQUATELY SUPPORT THE LOADS IMPOSED BY THE PANEL SYSTEM AND TRANSFER THEM SAFELY TO THE BUILDING STRUCTURE.
4. DESIGN LOADS MUST BE CALCULATED BY A PROFESSIONAL ENGINEER OR ARCHITECT FOR EACH PROJECT. THE PROJECT PRESSURE CANNOT EXCEED THE DESIGN PRESSURE LISTED ON THIS SHEET.
5. ALL ANCHORS SECURING THE SYSTEM TO PRESSURE TREATED WOOD SHALL BE CAPABLE OF RESISTING CORROSION CAUSED BY THE CHEMICALS IN THE WOOD.
6. MATERIALS INCLUDING BUT NOT LIMITED TO STEEL/METAL SCREWS THAT COME INTO CONTACT WITH OTHER DISSIMILAR MATERIALS SHALL BE PROTECTED PER FBC REQUIREMENTS.
7. NO INCREASE IN ALLOWABLE STRESS HAS BEEN USED IN THE DESIGN OF THIS PRODUCT. Cd=1.6 WAS USED FOR WOOD SCREWS ONLY.
8. FASTENER EMBEDMENTS LISTED ARE BEYOND WALL DRESSING OR STUCCO. FASTENERS IN METAL STUDS MUST FULLY PENETRATE THE STUD WALL WITH 3 ADDITIONAL THREADS BEYOND.
9. ACM PANEL IS ALUCOBOND 4mm ALUMINUM PANEL WITH FR CORE (SEE SHEET 5)
10. ALUMINUM EXTRUSIONS ARE 6063-T5 MIN.

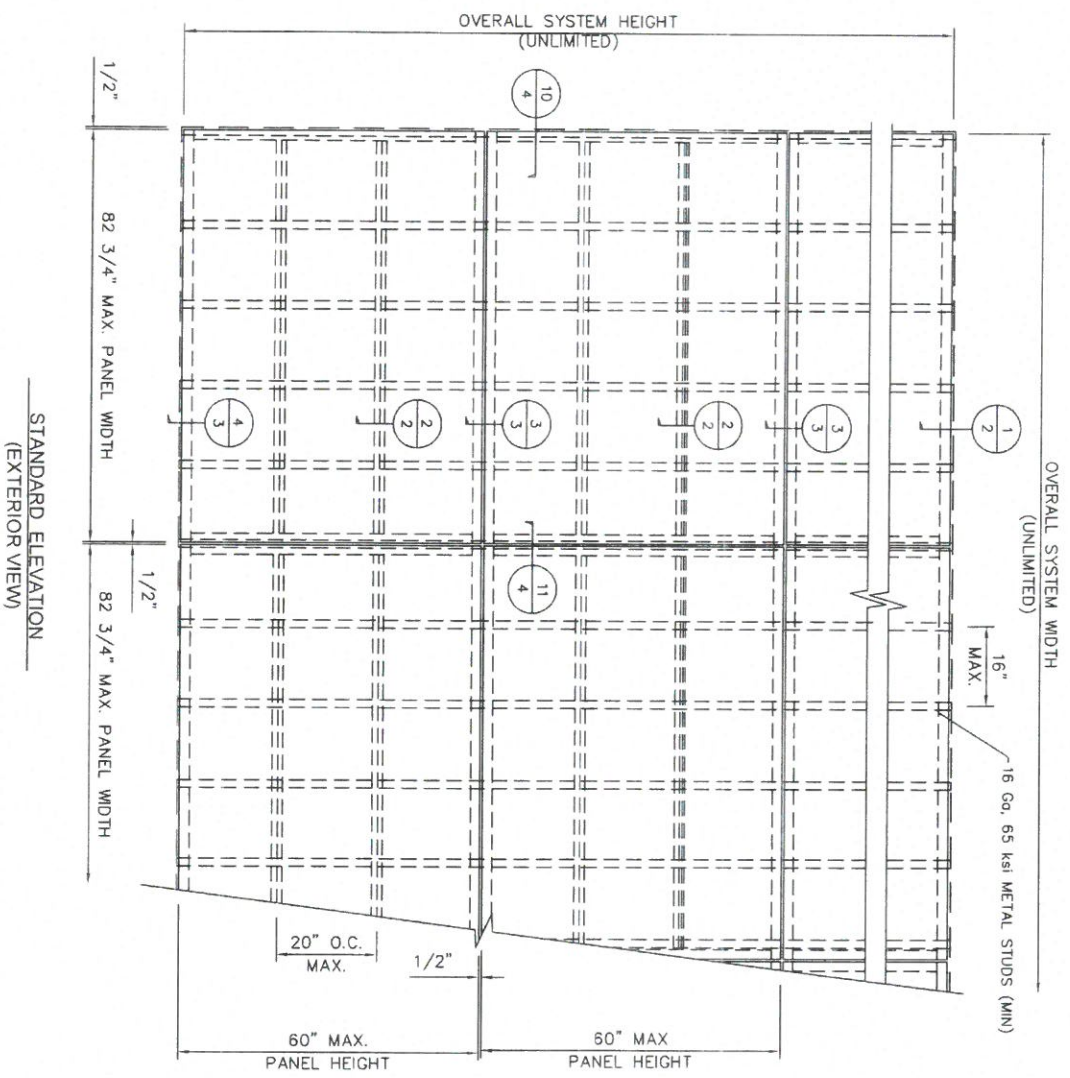

DESIGN PRESSURE
+/- 130 Psf

**ABRAMS**  
ARCHITECTURAL PRODUCTS  
7260 DELTA CIRCLE  
AUSTELL, GA 30106  
Phone: 770-748-8728  
Fax: 770-748-8839

DMG: AAP-700  
SHEET: 1/5

AAP-700  
(MALE/FEMALE)  
WALL CLADDING  
SYSTEM

SCOTT WOLTERS  
FL PE# 92354

WOLTERS ENGINEERING  
(CO.# 27194)  
15211 97th ROAD N  
WEST PALM BEACH, FL 33411  
(561) 225-1982

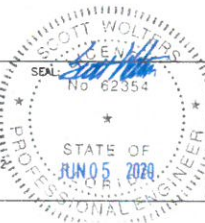

1ST SUBMITTAL	6/4/20
PRINTS ISSUED FOR	REV.# DATE

ALTERNATE DETAILS ON CONCRETE/CMU:

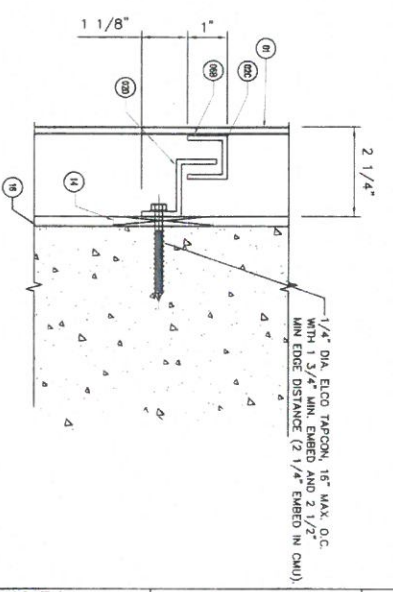
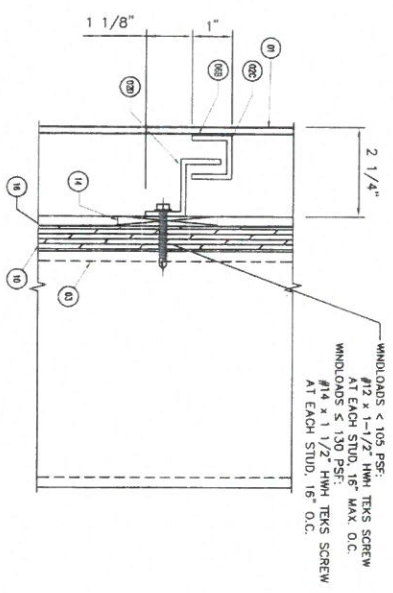
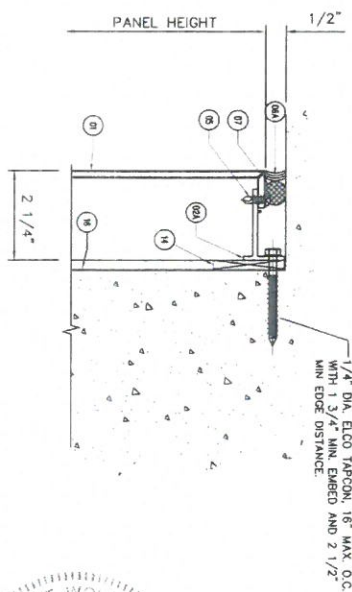
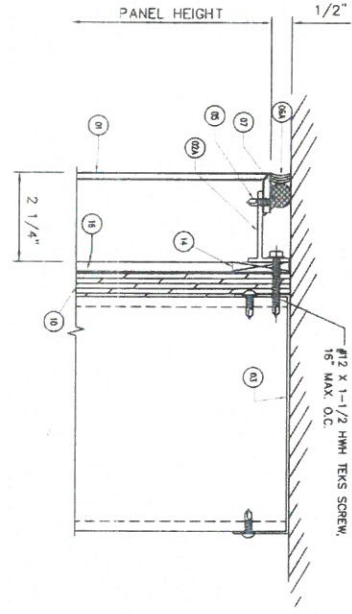

WINDLOADS < 105 PSF:  
 #12 x 1-1/2" HMM TEK SCREW  
 #17 EACH STUD, 16" MAX. O.C.  
 WINDLOADS > 105 PSF:  
 #14 x 1 1/2" HMM TEK SCREW  
 AT EACH STUD, 16" O.C.

1/4" DIA. ELO TAPCON, 16" MAX. O.C.  
 WITH 1 3/4" MIN. EMBED AND 2 1/2"  
 MIN EDGE DISTANCE (2 1/4" EMBED IN CMU)

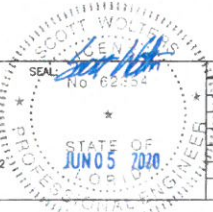

SCOTT WOLTERS  
 FL PE# 62354  
 WOLTERS ENGINEERING  
 (CORP) 27194  
 15211 9TH ROAD N  
 WEST PALM BEACH, FL 33412  
 (561) 225-1982

AAP-700  
 (MALE/FEMALE)  
 WALL CLADDING  
 SYSTEM

**ABRAMS**  
 ARCHITECTURAL PRODUCTS  
 7280 DELTA CIRCLE  
 AUSTELL, GA 30166  
 Phone: 770-745-9726  
 Fax: 770-745-8839  
 DWG: AAP-700  
 SHEET: 2/5

NO.	DESCRIPTION	DATE
1	1ST SUBMITTAL	6/4/20
2	PRINTS ISSUED FOR	REV # DATE



ALTERNATE DETAILS ON CONCRETE/CMU:

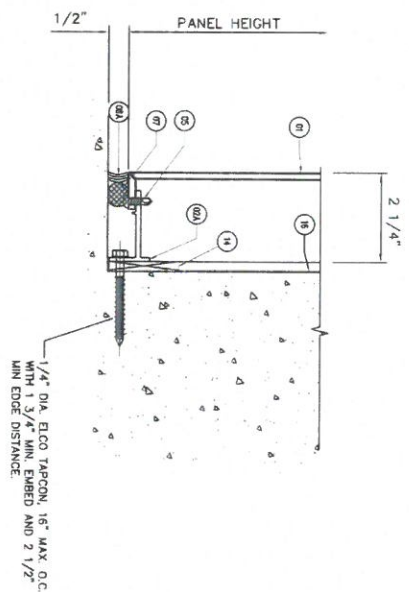
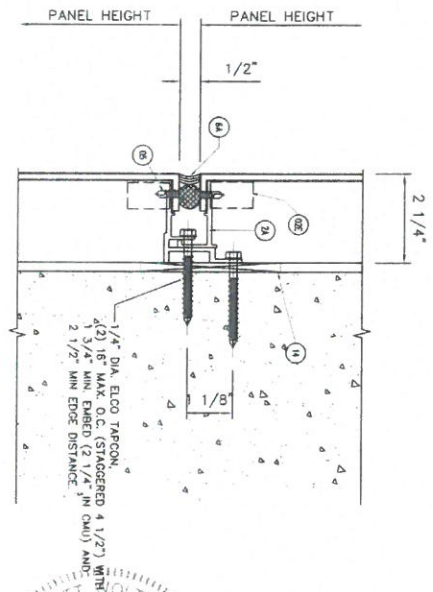
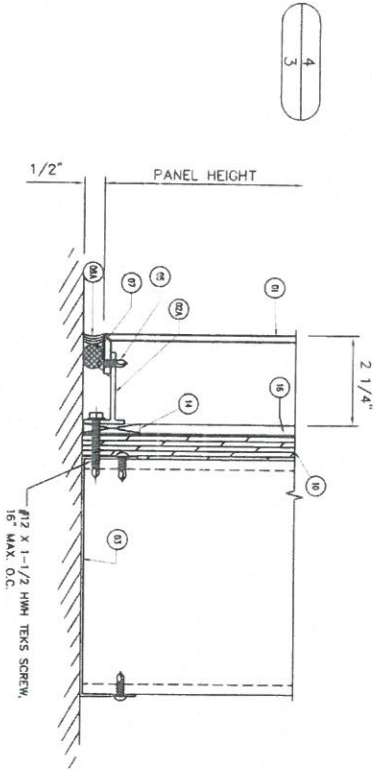
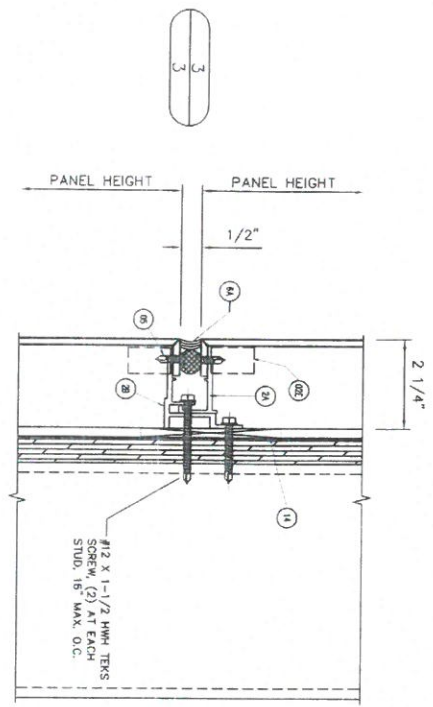

SCOTT WOLTERS  
FL PE# 62354  
STATE OF FLORIDA  
JUN 05 2020  
PROFESSIONAL ENGINEER

SCOTT WOLTERS  
FL PE# 62354  
WOLTERS ENGINEERING  
(COA# 27194)  
15211 97TH ROAD N  
WEST PALM BEACH, FL 33412  
(561) 225-1982

AAP-700  
(MALE/FEMALE)  
WALL CLADDING  
SYSTEM

**ABRAMS**  
ARCHITECTURAL PRODUCTS  
7290 DELTA CIRCLE  
AUSTELL, GA 30106  
PHONE: 770-745-8228  
FAX: 770-745-8838

DWG: AAP-700  
SHEET: 3/5

1ST SUBMITTAL	6/4/20
PRINTS ISSUED FOR	REV.#
	DATE

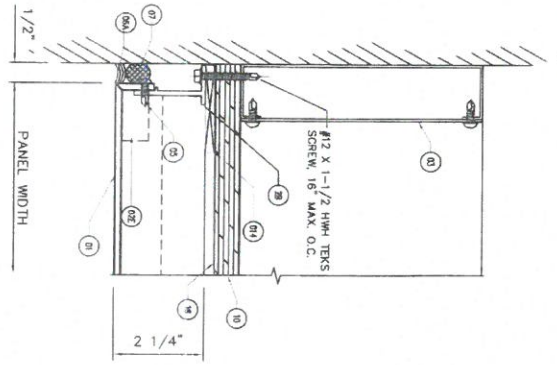

10  
4

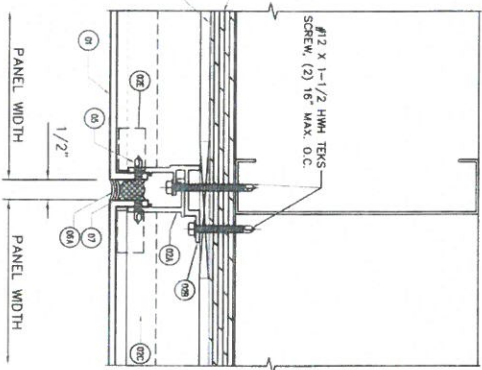

11  
4

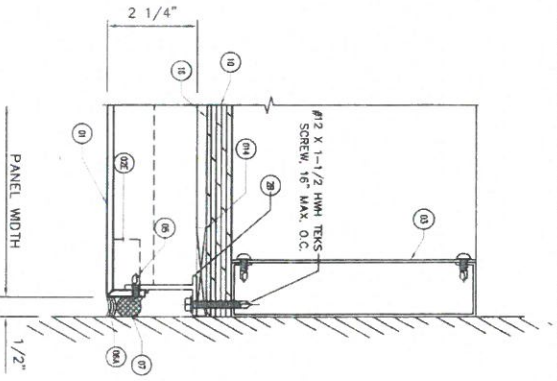

12  
4

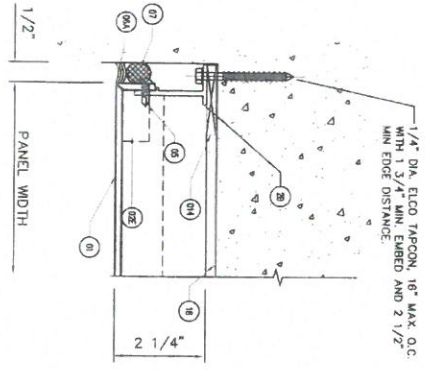

1/4" DIA. ELOCO TAPCON, 16" MAX. O.C. WITH 1 3/4" MIN. EMBED AND 2 1/2" MIN. EDGE DISTANCE.

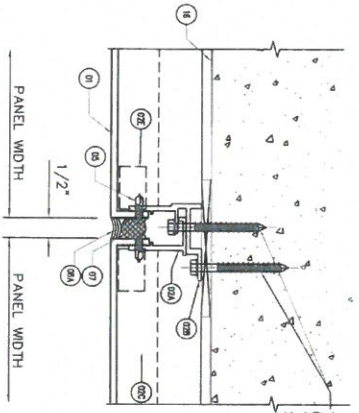

1/4" DIA. ELOCO TAPCON, (2) 16" MAX. O.C. WITH 1 3/4" MIN. EMBED AND 2 1/2" MIN. EDGE DISTANCE.

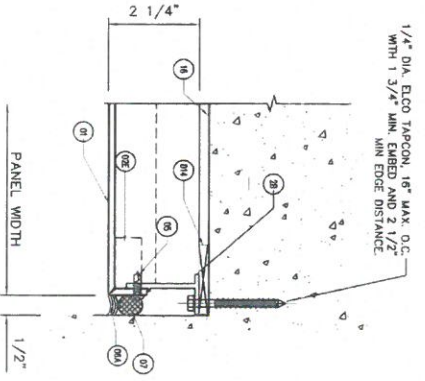

1/4" DIA. ELOCO TAPCON, 16" MAX. O.C. WITH 1 3/4" MIN. EMBED AND 2 1/2" MIN. EDGE DISTANCE.

ALTERNATE DETAILS ON CONCRETE CMU:



1ST SUBMITTAL	6/4/20
PRINTS ISSUED FOR	REV.# DATE

AAP-700  
(MALE/FEMALE)  
WALL CLADDING  
SYSTEM

SCOTT WOLTERS  
FL PE# 82354  
WOLTERS ENGINEERING  
(CO.# 27194)  
13211 9TH ROAD N  
WEST PALM BEACH, FL 33412  
(561) 225-1982

**ABBRAVMS**  
ARCHITECTURAL PRODUCTS  
7280 DELTA CIRCLE  
AUSTELL, GA 30168  
Phone: 770-746-8728  
Fax: 770-746-8838  
DWG: AAP-700  
SHEET: 4/5

