

WOLTERS ENGINEERING

ENGINEERING, DRAFTING, CONSULTING

15211 97th Road N
West Palm Beach, FL 33412
Ph/Fx: (561) 225-1982

PRODUCT EVALUATION

PRODUCT: ABRAMS AAP-950 (DRY JOINT) WALL CLADDING SYSTEM

MANUFACTURER: ABRAMS ARCHITECTURAL PRODUCTS
7260 DELTA CIRCLE
AUSTELL, GA 30166

To all concerned,

The AAP-950 (Dry Joint) Wall Cladding System, manufactured by Abrams Architectural Products, consists of formed 1/8"(3 mm) aluminum plate panels (3003-H14 Alloy) with extruded aluminum stiffeners. The panels are directly fastened to 5/8" CDX plywood over 16 Ga. metal stud framing (min). The system has been tested per TAS 201, 202, and 203 by Intertek B&C, with results shown in test report K3255.07-550-18.

Technical Documentation:

1. Drawing "AAP-950" dated 6/4/20, signed and sealed by Scott Wolters, PE.
2. Test Report listed above by Architectural Testing, Inc. signed and sealed by Vinu Abraham, PE.
3. Supplemental Calculations to support "AAP-950" drawing, signed and sealed by Scott Wolters, PE.

I have reviewed this submittal per the requirements of FAC Product Approval Rule Chapter 61G20-3.005 (4). Based on the limitations listed below and those provided in the documents above, this product meets all the requirements of the 6th Edition (2017) Florida Building Code generally, and chapters 14, 16, and 20 specifically, including the HVHZ provisions.

Limitations: This Aluminum Panel System is small missile impact resistant, and approved for use inside and outside of the HVHZ. Elevations in windborne debris regions below 30 ft may only be installed over wall types listed in FBC Section 1626.4.

<u>Overall Dimensions:</u>	Maximum Panel Width:	82 3/4"
	Maximum Panel Height:	60"
	Maximum Stiffener Spacing:	20"
	Maximum Design Pressure:	+/- 130 psf

This system is further limited as noted in installation drawing "AAP-950"

If you have any questions or need more information concerning this approval please contact me.

Thank you,

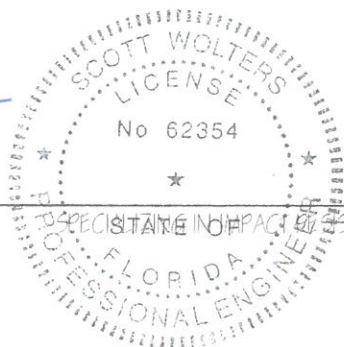

Scott Wolters
FL PE# 62354

JUN 05 2020

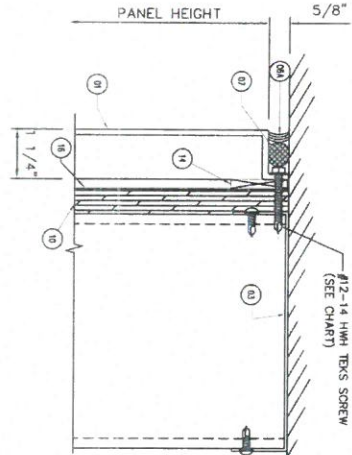

RESISTANT CURTAIN WALLS, STOREFRONTS, & WINDOWS

ALTERNATE DETAILS ON CONCRETE/CMU:



HEAD/SILL FASTENERS		
FASTENER TYPE	PANEL HEIGHT (IN)	ALLOWABLE PRESSURE (PSI)
#12-14 TEK SCREW (1) PER STUD	34	50
	48	103
	54	83
	60	75
#12-14 TEK SCREW (2) PER STUD (SEE SECTION 2-2)	60	130

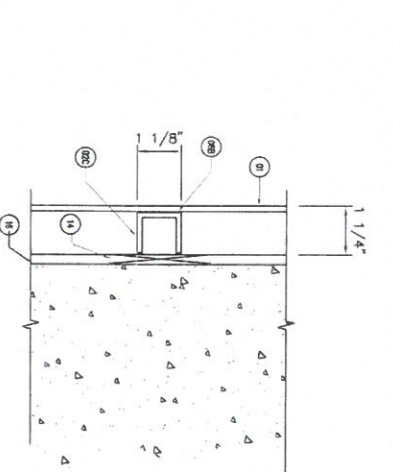
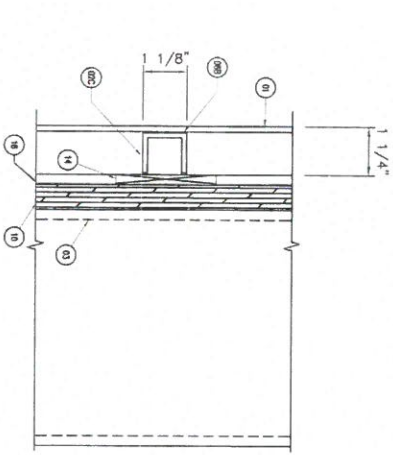
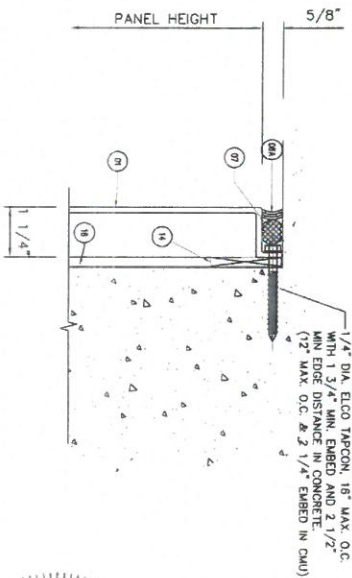

1ST SUBMITTAL	6/4/20
PRINTS ISSUED FOR	REV.# DATE

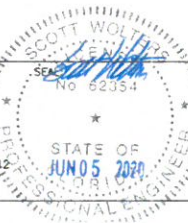

SCOTT WOLTERS
FL PE# 62354
WOLTERS ENGINEERING
(CO.# 27194)
15211 97TH ROAD N
WEST PALM BEACH, FL 33412
(561) 225-1982

AAP-950
(DRY JOINT)
WALL CLADDING
SYSTEM

ABRAMS
ARCHITECTURAL PRODUCTS
7290 DELTA CIRCLE
AUSTELL, GA 30186
Phone: 770-745-8728
Fax: 770-745-8838
DWG: AAP-950
SHEET: 2/5

ALTERNATE DETAILS ON CONCRETE/CMU

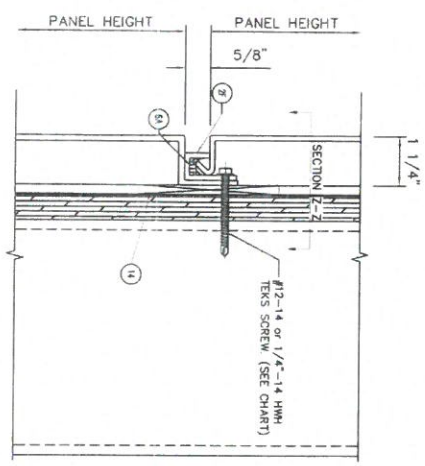

HORIZONTAL JOINT FASTENERS		
FASTENER TYPE	AVERAGE PANEL HEIGHT (in)	ALLOWABLE PRESSURE (psf)
#12-14 THKTS SCREW (2) PER STUD	34	130
	42	107
	48	83
	54	75
	60	
1/4"-14 THKTS SCREW (2) PER STUD	40	130
	48	107
	54	98
	60	88

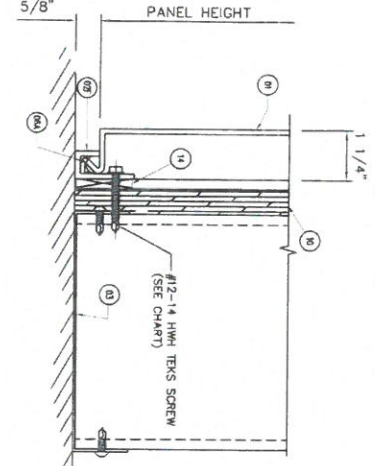
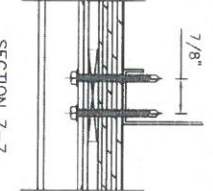

HEAD/SILL FASTENERS		
FASTENER TYPE	PANEL HEIGHT (in)	ALLOWABLE PRESSURE (psf)
#12-14 THKTS SCREW (1) PER STUD	34	130
	42	107
	48	83
	54	75
	60	
#12-14 THKTS SCREW (2) PER STUD (SEE SECTION Z-Z)	60	130

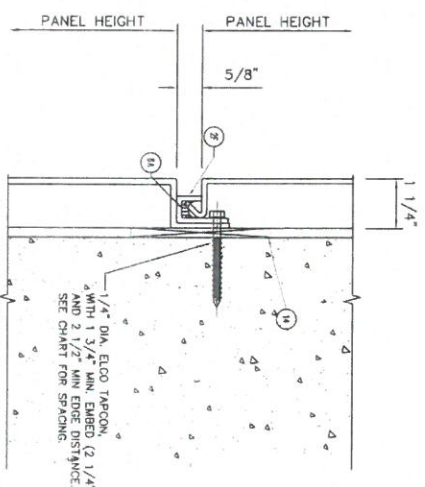

HORIZONTAL JOINT FASTENERS				
AVERAGE PANEL HEIGHT (in)	CONCRETE (3000 PSI MIN)		GROUT-FILLED CMU (ASTM C90)	
	FASTENER ALLOWABLE SPACING (in)	FASTENER ALLOWABLE PRESSURE (psf)	FASTENER ALLOWABLE SPACING (in)	FASTENER ALLOWABLE PRESSURE (psf)
48	10	130	7	130
	12	116	9	109
	16	89	12	82
54	9	130	6 1/2	130
	12	105	9	97
	16	79	12	72
60	5	130	6	130
	8	90	8	90
	16	71	12	65

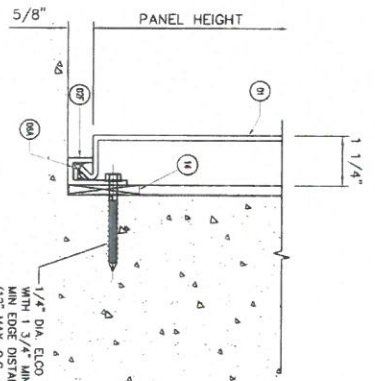

1/4" DIA. EPOXY TAPCON, 16" MAX. O.C. WITH 1 3/4" MIN. EMBED AND 2 1/2" MIN. SPACING IN CONCRETE (12" MAX. O.C. & 2 1/4" EMBED IN CMU)

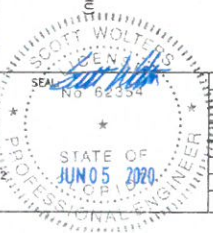

SCOTT WOLTERS
FL PE# 62354
WOLTERS ENGINEERING
(CO.# 27194)
15211 17TH ST. N
WEST PALM BEACH, FL 33412
(561) 225-1982

AAP-950
WALL CLADDING
SYSTEM

ABRAMS
ARCHITECTURAL PRODUCTS
7290 DELTA CIRCLE
AUSTIN, TX 78728
Phone: 770-746-8928
Fax: 770-746-8838

DMG: AAP-950
SHEET: 3/5

1ST SUBMITTAL	6/4/20
PRINTS ISSUED FOR	REV.# DATE

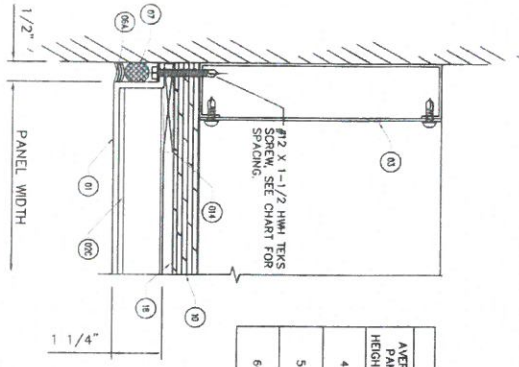

JAMB FASTENERS			
AVERAGE PANEL HEIGHT (in)	FASTENER SPACING (in)	ALLOWABLE PRESSURE (psf)	
48	11	130	
	12	125	
	16	93	
54	10	130	
	12	111	
	16	83	
60	9	130	
	12	100	
	16	72	

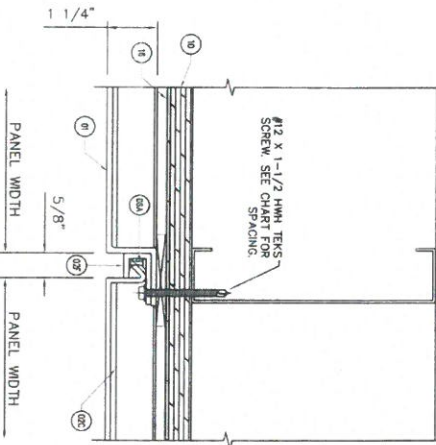

VERTICAL JOINT FASTENERS			
AVERAGE PANEL HEIGHT (in)	FASTENER SPACING (in)	ALLOWABLE PRESSURE (psf)	
48	5 1/2	130	
	8	82	
	16	46	
54	5	130	
	8	83	
	12	55	
60	4	130	
	8	75	
	16	37	

10
4

11
4

ALTERNATE DETAILS ON CONCRETE/CMU:

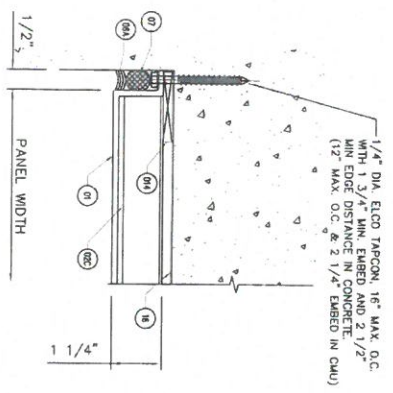

1/4" DIA. ECG TAPCON, 16" MAX. O.C. MIN. EMBED AND 2 1/2" MIN. EDGE DISTANCE IN CONCRETE (12" MAX. O.C. & 1/4" EMBED IN CMU)

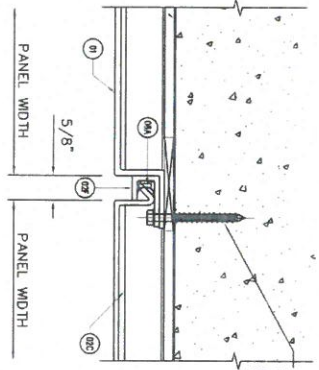

1 3/4" DIA. ECG TAPCON, AND 2 1/2" MIN. EDGE DISTANCE. SEE CHART FOR SPACING.

VERTICAL JOINT FASTENERS				
AVERAGE PANEL HEIGHT (in)	CONCRETE (3000 psi MIN)		GROUT-FILLED CMU (ASTM C90 MIN)	
	FASTENER SPACING (in)	ALLOWABLE PRESSURE (psf)	FASTENER SPACING (in)	ALLOWABLE PRESSURE (psf)
48	10	130	7	130
	12	118	9	109
	16	89	12	82
54	9	130	6 1/2	130
	12	100	12	72
	16	79	12	72
60	8	130	6	130
	12	95	9	87
	16	71	12	65



SCOTT WOLTERS
FL PE# 62354
WOLTERS ENGINEERING
(CO.# 27194)
15211 97TH ROAD N
WEST PALM BEACH, FL 33411
(561) 225-1982

AAP-950
WALL CLADDING
SYSTEM

ABRAMS
ARCHITECTURAL PRODUCTS
7290 DELTA CIRCLE
AUSTIN, TX 78728
Phone: 770-745-8726
Fax: 770-745-8839

DWG: AAP-950
SHEET: 4/5

1ST SUBMITTAL	6/4/20
PRINTS ISSUED FOR	REV.# DATE

BILL OF MATERIALS		
MARK	DESCRIPTION	NOTES
1	1/8" (3MM) ALUMINUM PANEL (3003-H14)	
2C	ALUMINUM STIFFENER EXTRUSION	6063-T5 (MIN)
2F	ALUMINUM J-TRIM EXTRUSION	6063-T5 (MIN)
3	METAL STUD SYSTEM (16 ga .65 ksi MIN)	
5	#8x3/4" PH GALV TEKS SCREW	
6A	DOW 795 SILICONE	
6B	DOW 1199 SILICONE	
7	BACKER ROD	
10	PLYWOOD SHEATHING (5/8" CDX MIN)	
14	SHIMS - HIGH IMPACT PLASTIC	
16	WATERPROOF MEMBRANE	

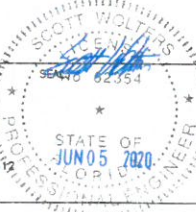
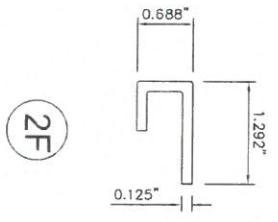
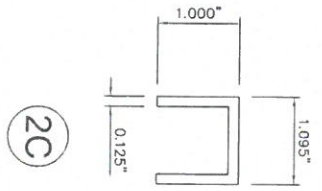

1ST SUBMITTAL	6/4/20
PRINTS ISSUED FOR	REV.#
	DATE

**AAP-950
WALL CLADDING
SYSTEM**

SCOTT WALTERS
FL PE# 62354
WALTERS ENGINEERING
(CO.# 27194)
15211 97TH ROAD N
WEST PALM BEACH, FL 33412
(561) 225-1982



ABRAMS
ARCHITECTURAL PRODUCTS
7280 DELTA CIRCLE
AUSTELL, GA 30166
Phone: 770-745-8728
Fax: 770-746-8839

DWG: AAP-950
SHEET: 5/5